



Accessories Damper Actuators

Accessories for Actuators
MD5/MD10/MD20/MD40/AF/LF

G-30-90

27 Jan 2006

AV8-25

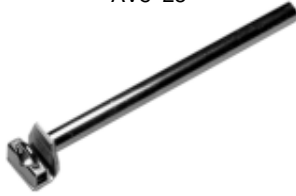

K-MD10

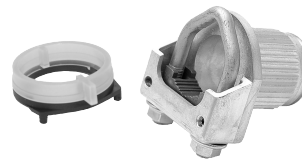

KH8



ZDB-AF



ZDB-LF



ZG-AF

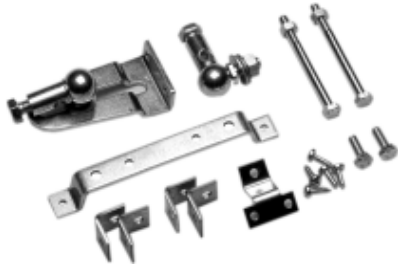

ZG-MD20

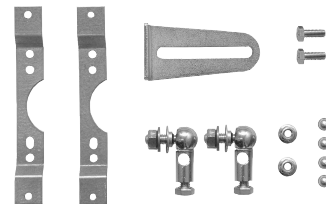

MECHANICAL ACCESSORIES

Name	Description	Part number	Actuators					
			MD5	MD10	MD20	MD40	LF	AF
AV8-25	Shaft extension Length approx. 250 mm (9.8 in.) For damper spindles 8-25 mm (0.32-0.98 in.) dia. or 10-25 mm (0.40-0.98 in.) square	914-1023-010		×	×		×	×
K-MD10	Reversible spindle clamp	914-1062-000		×				
KH8	Universal damper crank arm Zinc-plated steel For damper spindles 10-18 mm (0.39-0.71 in.) dia. or 10-14 mm (0.39-0.55 in.) square Slot width 8.2 mm (0.32 in.)	914-1021-000			×		×	×
ZDB-AF	Angle of rotation limiter	914-1026-000						×
ZDB-LF	Angle of rotation limiter and pointer	914-1045-000					×	
ZG-AF	Damper linkage kit For flat and side mounting	914-1025-000						×
ZG-MD20	Damper linkage kit	914-1063-000			×			

MD-S2



ELECTRICAL ACCESSORIES

Name	Description	Part number	Actuators					
			MD5	MD10	MD20	MD40	LF	AF
MD-S1	Auxiliary switch, add-on 1xSPDT 1 mA...3(0.5) A, 250 V AC	914-1060-000	×	×	×	×		
MD-S2	Auxiliary switch, add-on 2xSPDT1 mA...3(0.5) A, 250 V AC	914-1061-000	×	×	×	×		